



THE RIPPER TIMES

Weekly Newsletter of Traralgon South Primary School

PRINCIPAL REPORT...

Give A Damn, Give A Can:

With thanks to the support of our school community, I am pleased to report we were able to donate 342 cans to this fantastic cause, driven by the Traralgon Central Rotary Club. With many in our school and wider community finding it tough at times, being able to promote this initiative has undoubtedly supported the growth of many of our RIPPER values within our students, particularly empathy and respect towards others. These canned food items will be forwarded to local charity organisations, where they can provide those in our local community hampers of goods when they fall into difficulty.

Literacy Teacher Practice:

With much of our current school improvement focus centred on improving our capacity as classroom teachers to implement an evidence-based instructional model, the Explicit Direct Instruction methodology, we have also been busily improving our professional knowledge and skills associated with the Science of Reading. More specifically, as an extension of the adjustments made to the way in which we teach reading in recent years, we have been exploring evidence-based assessments to support our delivery method. Currently, all students within the school are being tested with the DIBELS Assessment, which is a series of very short tests that focus on the big ideas and critical skills of reading. As an example, outcomes of these DIBELS tests provides teachers with valuable information about a child's ability in phonemic awareness, blending, decoding, reading fluency, reading accuracy, and the ultimate goal of reading instruction – reading comprehension. Most importantly, test outcomes also support teachers in identifying what skills need to be developed next with your child, ensuring their teaching and learning program continues to be delivered at the correct point of need.

With a set of data that compares student results from the beginning of the year to the middle of the year (now), teachers will begin to triangulate this information against their other assessment data sets, both formative and summative, supporting them to confidently provide a Teacher Judgement in the upcoming student semester reports (this is the 'dot'). Whilst this work is relatively new and exciting, I encourage parents and guardians who are interested to know more to have a discussion with your child's teacher.

Principal: Joel Blythman

A: 13-19 Keith Morgan Drive,
Traralgon South, VIC, 3844

P: (03) 5195 5244

E: traralgon.south.ps@education.vic.gov.au

W: www.traralgonstps.vic.edu.au



www.facebook.com/traralgonsouthprimaryschool/





THE RIPPER TIMES

Weekly Newsletter of Traralgon South Primary School

Inclusive Schools Playground Update:

Over the previous week(s), classroom teachers have been able to share the final design of our Inclusive Schools playground to students. This has been a thorough process completed in consultation with the design architects, our school, and my many questions to children about playground preferences whilst I'm in the yard on duty throughout this year! I am pleased to share this design with our school community below, and once the tender process has concluded, I will be in a better position to provide a stronger indication of suggested project completion timelines. This will be an exciting addition to the front of our school and I can't wait to see it come to life!

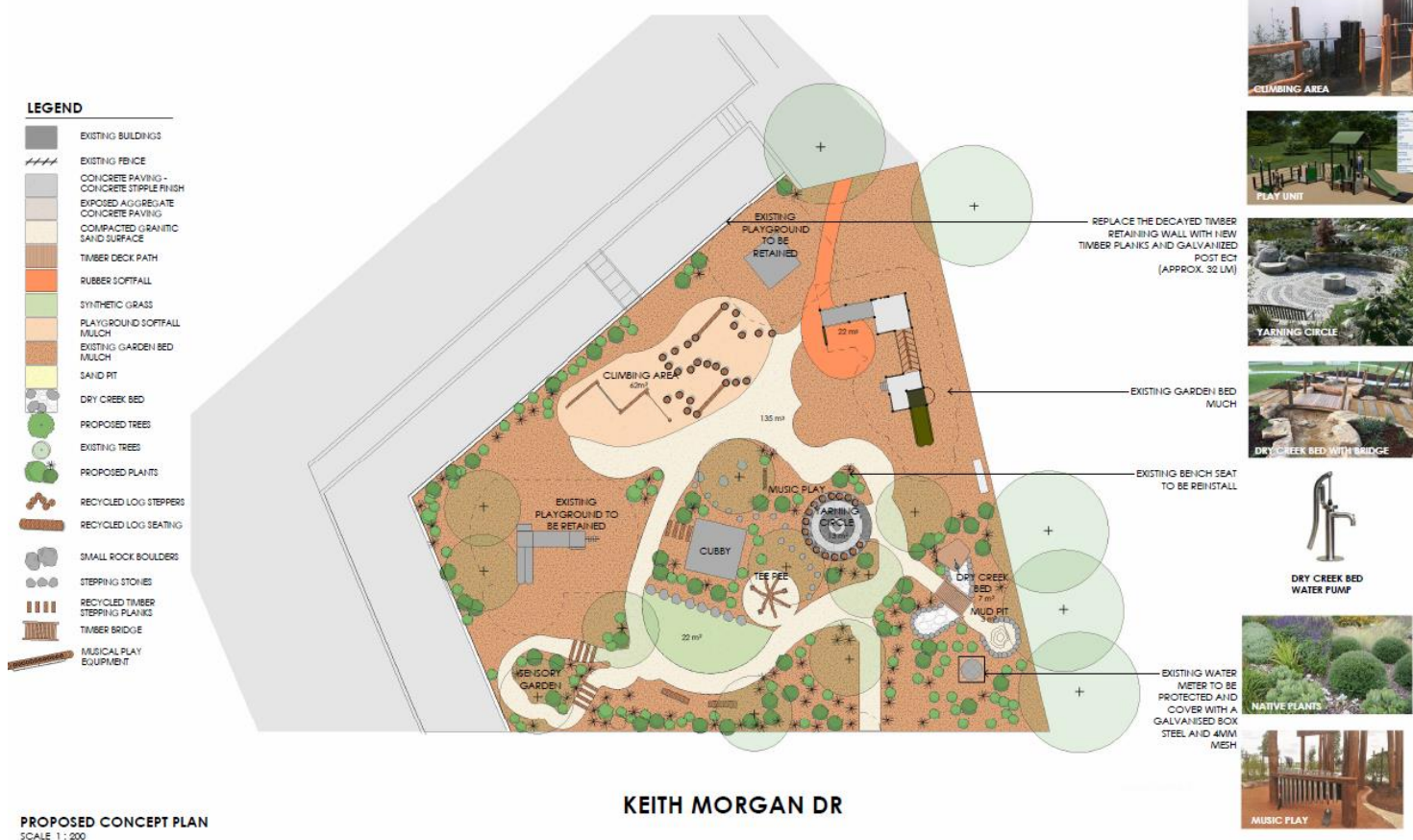

2025 Enrolments:

With a number of younger siblings of current students attending the neighbouring Pre-School, please be reminded of the Department of Education timelines for 2025 Prep enrolments, with

Principal: Joel Blythman

A: 13-19 Keith Morgan Drive,
Traralgon South, VIC, 3844

P: (03) 5195 5244

E: traralgon.south.ps@education.vic.gov.au

W: www.traralgonstps.vic.edu.au

 www.facebook.com/traralgonsouthprimaryschool/





THE RIPPER TIMES

Weekly Newsletter of Traralgon South Primary School

Friday 26 July the nominated due date for these. I am sure many parents/carers will be feeling like they have only just got into a Pre-School routine and are possibly not yet ready to even think about school enrolment, hence this polite reminder message. Enrolment packages can be collected from the Pre-School, our General Office, or from our website (under the 'Prospective Families' tab). Of course, if you would like to visit our school to discuss enrolment for your child in 2025 in more detail, I would be most willing to support this and I encourage you to reach out to arrange a mutually convenient time to do so.

Take care,

Joel Blythman

DATES TO REMEMBER...

29 th May	Wednesday	School Bake Potato Lunch Orders Due – 9:00am
31 st May	Friday	School Hot Lunch Day
3 rd June	Monday	Scholastic Book Club LOOP Online Orders Close
		School Council Meeting
10 th June	Monday	King's Birthday Public Holiday
28 th June	Friday	End of Term 2
15 th July	Monday	First Day Term 3
25 th July	Thursday	Student Free Day

Principal: Joel Blythman

A: 13-19 Keith Morgan Drive,
Traralgon South, VIC, 3844

P: (03) 5195 5244

E: traralgon.south.ps@education.vic.gov.au

W: www.traralgonstps.vic.edu.au



www.facebook.com/traralgonsouthprimaryschool/

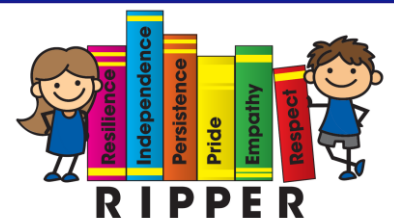



THE RIPPER TIMES

Weekly Newsletter of Traralgon South Primary School

RIPPER STUDENT AWARDS...



Prep/1	Tilly K	For consistently showing resilience, persistence and respect in the classroom.
1/2	Kenzie P	For showing wonderful resilience and showing kindness and patience to others.
2/3	Poppy M	For consistently displaying RIPPER values.
4/5	Oliver M	For making a conscious effort of his learning choices. Keep showing independence to complete your work, it's awesome to see!
5/6	Jake K	For his independence and enthusiasm during writing. He's always willing to share and get feedback.
Art	Chloe B	For her beautifully painted concentric circles inspired by the artist, Kandinsky.

Principal: Joel Blythman

A: 13-19 Keith Morgan Drive,
Traralgon South, VIC, 3844

P: (03) 5195 5244

E: traralgon.south.ps@education.vic.gov.au

W: www.traralgonstps.vic.edu.au



www.facebook.com/traralgonsouthprimaryschool/





THE RIPPER TIMES

Weekly Newsletter of Traralgon South Primary School

Mid Valley Shopping Centre Sculpture Competition

Mid Valley Shopping Centre has invited our school to participate in a SCULPTURE COMPETITION for World Environment Day with the chance of our school WINNING a \$1000 Mid Valley Shopping Centre shopping spree for our school!

World Environment Day is celebrated annually on 5th June and encourages awareness and action for the protection of the environment.

The students in Grade 5/6 have taken up the challenge to build multiple sculptures/scenes made of recycled materials.

Their imagination has run wild with wonderful ideas!!!

The sculptures will be on display at Mid Valley shopping centre from Monday 3rd to Sunday 16th June allowing customers the opportunity to vote for their favourite sculpture. The school with the most votes will win a \$1000 Mid Valley gift card! The gift card can be used to purchase new school supplies or perhaps healthy treats for students to share to celebrate the win!

So please get over to Mid Valley during this time and vote for our wonderful school and the fabulous entries we are about to submit. The more votes our school has the better chance we have at winning a voucher for our school to spend on more wonderful resources.



Principal: Joel Blythman

P: (03) 5195 5244

W: www.traralgonsouthps.vic.edu.au

A: 13-19 Keith Morgan Drive,
Traralgon South, VIC, 3844

E: traralgon.south.ps@education.vic.gov.au



www.facebook.com/traralgonsouthprimaryschool/





THE RIPPER TIMES

Weekly Newsletter of Traralgon South Primary School



Tuesday 29th October to Friday 1st November 2024

Would you like to take some time out to refresh and boost your wellbeing?

Join us for this Carer Camino as we walk the Great Southern Rail Trail from Fish Creek to Port Welshpool over 4 days / 3 nights.

Starting at the Fish Creek Hotel, we will walk 40 km to finish on the jetty at Port Welshpool, walking an average of 10 - 12 km each day (there is a bus available for those who require a pick up along the way).

Morning meditation sessions and afternoon wellbeing workshops will be facilitated. Each person will develop a Wellbeing Plan with simple strategies to care for your wellbeing when you are back at home.

Accommodation will be provided in Foster at the Prom Country Lodge, and meals at local venues.

The Carer Camino is open to carers who live in Gippsland and care for a person who meets the Disability Services Act 1986 eligibility criteria.

Accommodation and food are included at no cost.

Interested? Give us a call on **1300 736 765** or email us at **admin@icg.asn.au**

Places finalised by Friday 20th September 2024

Principal: Joel Blythman

P: (03) 5195 5244

W: www.traralgonsouthps.vic.edu.au

A: 13-19 Keith Morgan Drive,
Traralgon South, VIC, 3844

E: traralgon.south.ps@education.vic.gov.au



www.facebook.com/traralgonsouthprimaryschool/

